



MODEL HOME
23107 70th St. E.
Buckley, WA 98321
www.soundbuilthomes.com

THE AINSWORTH

2,788 SQUARE FOOT, RAMBLER WITH LOFT



4 BEDS/3 BATHS



THE AINSWORTH PLAN IS A SPACIOUS RAMBLER WITH OVER 2,700 FEET OF LIVING SPACE INCLUDING A LARGE BONUS ROOM, BEDROOM, AND FULL BATH IN THE UPSTAIRS LOFT. THE DOWNSTAIRS LIVING AREAS ARE HIGHLIGHTED BY AN OPEN CONCEPT GREAT ROOM/KITCHEN/NOOK, EXPANDED OUTDOOR LIVING, AND TWO ADDITIONAL BEDROOMS INCLUDING ONE WITH FRENCH DOORS – THE PERFECT OPTION TO USE AS A HOME OFFICE OR DEN.

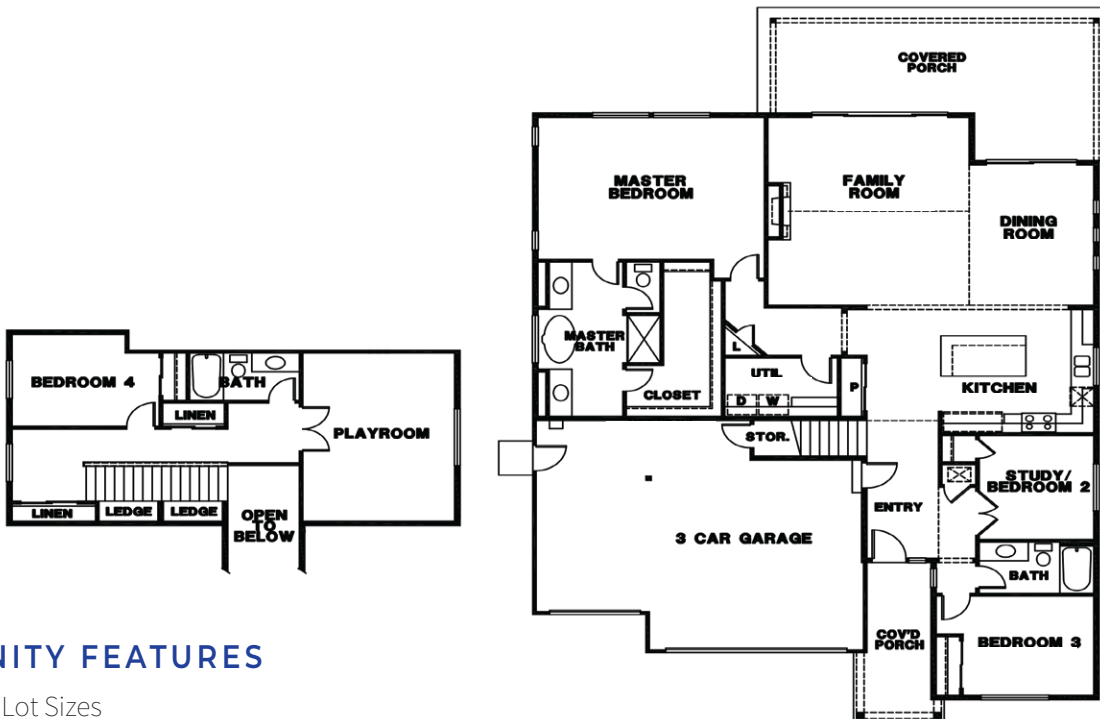

* OUTDOOR FIREPLACES ARE AN OPTIONAL UPGRADE ONLY

COMMUNITY FEATURES

- Large Lot Sizes
- Mt. Rainier Views
- Rambler Plans
- Contemporary Design

WWW.SOUNDBUILTHOMES.COM

Headquartered and centrally located in the South Puget Sound, Soundbuilt Homes has built new home communities in King, Pierce and Thurston Counties for nearly four decades. We truly are Washington's expert home builder.



www.presgroupnewhomesWA.com
253-256-5435