

THE AINSWORTH

SQUARE FOOTAGE: 2,788

BEDROOMS: 4

BATHS: 3

GARAGE: 3

DESIGN HIGHLIGHTS:

DEN OR BEDROOM, GREAT ROOM,
MASTER SUITE ON THE MAIN,
BONUS ROOM UPSTAIRS

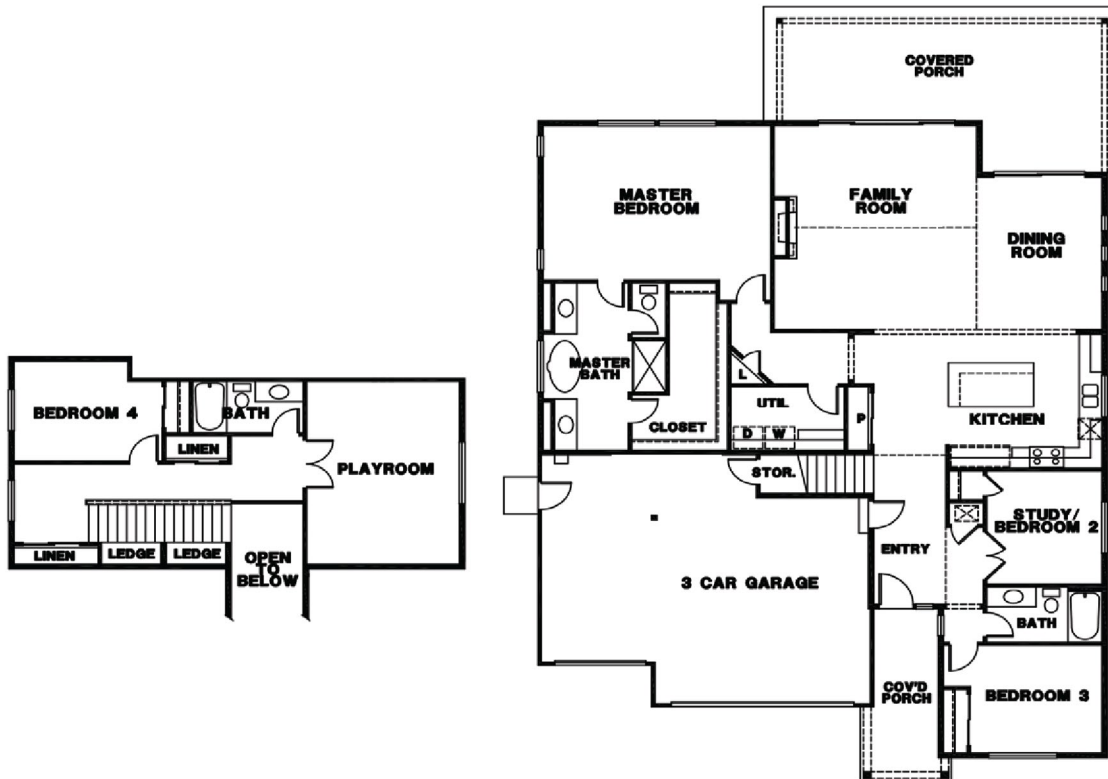

* OUTDOOR FIREPLACES ARE AN OPTIONAL UPGRADE ONLY